



Hoover's quick & snappy start up guide.

90 cm Undermount
Rangehood



Model #: HV-C90RU
Version #: V1.0
After Sales Support 1300 886 649

Let's get your rangehood up and running!

Welcome to your new Hoover rangehood! We hope that this product brings you many years of enjoyment.

NOTE: This rangehood must be professionally installed to an appropriately earthed wiring system by a licensed electrician. Do not try to install the rangehood yourself. Doing so will expose you to danger and could invalidate any warranty or liability claims.

Comprehensive installation instructions, diagrams and safety advice are provided in the supplied instruction manual. Make sure to make it available to the installer.

Venting Modes

- Before installing the rangehood, please check and ensure that the two levers on the motor are set to the desired venting mode - "DUCTING" (right) or "RECIRCULATING" (left).

Indoor Circulation Mode

- This mode will vent the air back into the kitchen (see Fig. 1a). It should only be used when it is not possible to use the outdoor ducting mode.
- To ensure that the mode is correct, remove the aluminium mesh filters and check that the two levers are in the "RECIRCULATING" position (see Fig. 1b).
- If you intend to use the rangehood with the air recirculating back into the kitchen, it is important that you use charcoal filters to absorb some of the cooking odours (see page 11 of the instruction manual for more information on how to purchase and install these filters).

Outdoor Ducting Mode

- This is the recommended extraction mode wherever possible for optimum performance. If you are able to install the exhaust duct to vent the air outside and operate your rangehood in outdoor ducting mode (see Fig. 1c), have your licensed installer follow the instructions on page 10 of the instruction manual.
- To ensure that the mode is correct, remove the aluminium mesh filters and check that the two levers are in the "DUCTING" position (see Fig. 1d).
- You will need to remove the charcoal filters and cover the front air outlet with the vent cover when using this mode.

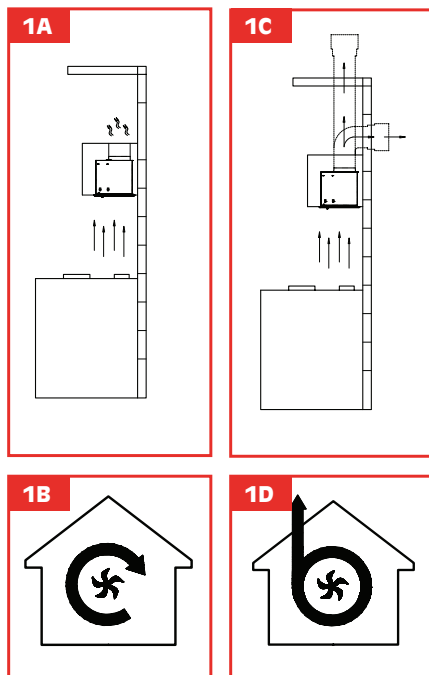

Switching on/off

- After the rangehood has been properly installed, insert the power plug into an appropriate electrical outlet and let the unit run for a few minutes prior to using it while cooking.
- Make sure the rangehood is properly connected to the power supply and the power is switched on at the outlet.

Control Panel

- Press the **Light** button to turn the two lamps on. Press this button again to turn the lamps off.
- Press the **High** button to run the fan motor at high speed.
- Press the **Mid** button to run the fan motor at medium speed.
- Press the **Low** button to run the fan motor at low speed.
- Press the **Stop** button to stop the motor from running.

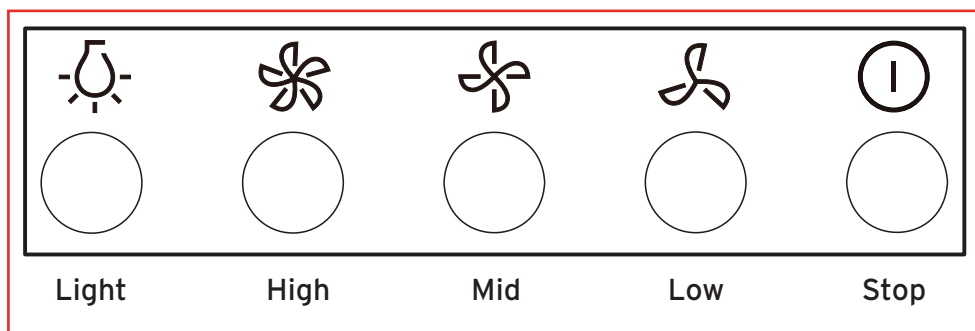

Hope you enjoy your new Hoover
rangehood.